

The Painswick Beacon

Volume 46 Number 2

May 2023

The Coronation of Charles III

Painswick will be celebrating the Coronation of King Charles III with numerous street parties around the village mainly on Sunday 7th May. On Monday 8th May you are invited to two further events arranged by Painswick Community Support and the WI as detailed below.



Coronation Community BBQ - 12-3pm

Painswick Community Support is pleased to be hosting a complimentary Community BBQ on the Painswick Recreation Ground on Monday 8th May, 12-3pm. The Painswick Centre will be providing a bar and we will be providing complimentary teas and coffees. We are excited that Sportily will be organising games and activities for the children.

To ensure we are catering sufficiently for all those who would like to attend we would be grateful if you would complete our form to give us an idea of numbers

Provide your food orders by scanning QR Code or typing in the website to your browser - <https://qrco.de/bdtOFH>

The event promises to be relaxed and informal. We will provide some gazebos for shelter but we ask villagers to bring their own picnic blankets and seating.



In keeping with the national "Big Help Out" theme of the day, we would like to invite our fellow clubs, societies and community organisations to showcase their activities, potentially to attract new members or volunteers. To date, Painswick Cricket Club, Painswick Rugby Club, Painswick Bowls Club, St. Mary's Church, the Flower Guild, the Local History Society and Slavutych Friendship Group have all confirmed attendance.

We can provide a table if helpful. Any offers of sweet/savoury finger nibbles on your table would be very welcome. Or if you have any other thoughts for the event, please let us know. Email us on painswickcommunity@gmail.com or call us on 07956203087. Please see our poster (above). Do let us know if you would like to join the celebration!

Yew Trees WI Coronation Cream Teas - from 2.30pm

Yew Trees WI are holding another of their popular cream teas to celebrate the Coronation of his Majesty Charles III. We will be open for business from 2.30pm in the Church Rooms. A cup of tea, two scones, jam and clotted cream will cost £3.50 and £1.00 more if you should want a second helping and why wouldn't you? Please come along and support us. All the proceeds will be donated to charity.

Those Broadham traffic lights ...

The County Council has published its proposed road safety scheme for the A46 below Broadham that it hopes will enable removal of the temporary traffic lights that have been there for well over a year. The scheme involves a series of measures to slow down traffic as it approaches the dip where the road crosses the culvert carrying the Wash Brook.

As traffic comes towards the dip from either direction, drivers will see first a 'SLOW' marking on the road followed by red 'countdown' stripes (three red stripes, then two, then one), then a red painted 'gateway' band marked 'SLOW' with an advisory 30 mph speed limit sign alongside. The road will narrow slightly through the dip, possibly be painted a buff colour, and with marker posts installed on the north-west side. The aim is to slow traffic down sufficiently for safe two-way operation without the need for traffic lights. Approaching from Painswick, the markings to slow traffic down will start only just after the 50mph signs at the end of the 30mph zone. Parish Councillor Andy Cash has suggested that it would be both simpler and more effective to extend the 30mph zone until just after the dip.

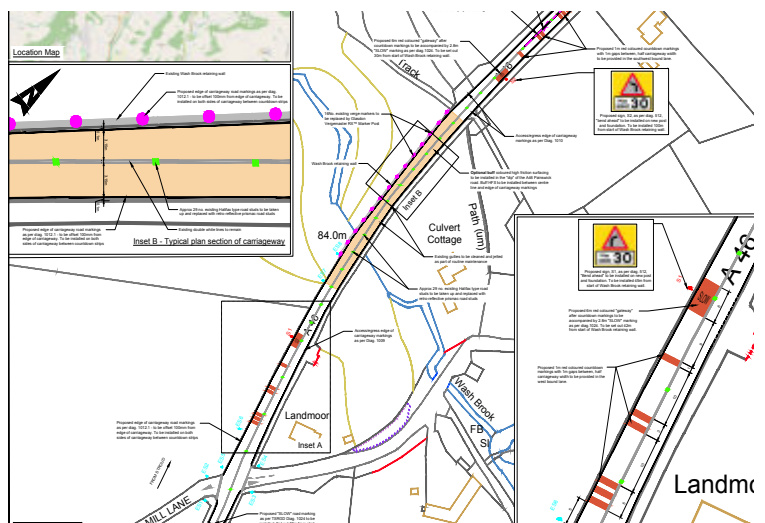

The proposals may seem a bit underwhelming, considering it has taken 15 months to come up with them, but Council engineers point out that the money is not currently available for any proposal involving barriers or physical restraints at the side of the road.

The proposals are now out for consultation and if approved could be implemented at some stage over the summer. It seems we still have the lights for some time yet.

PARISH COUNCIL NEWS by Terry Parker from the meetings held on 19th April

Reports upon meetings of the Parish Council cannot help but be selective, if only because of space constraints. We try to highlight points of widest public interest, based upon what we see and hear.

The full minutes of Council and committee meetings are available for scrutiny at the Council's office and on-line at the Parish Council's web site.

PLANNING COMMITTEE

Present: Cllr Rob Lewis (Chairman), Andy Cash, Adrian Gyde, Sandra Hunkin, Ian Massey, Roey Parker and Martin Slinger.

Apologies: Cllrs Ann Daniels and Rosie Nash.

Also in attendance: District Councillor Julie Job, six members of the public and one member of the Press.

Matters requiring a decision.

S.23/0565/FUL. Painswick House, Gloucester Road. Conversion of existing visitor centre/café to two dwellings.
S.23/0566/LBC. Painswick House, Gloucester Road. Conversion to residential use and associated works.

The Committee agreed to object to these applications. Concern was expressed about the effect on the natural environment and the impact on the setting of the Rococo Garden.

S.23/0649/FUL.

Horsepools Piece, Paul Mead, Edge. Proposed replacement dwelling and detached garage. The Committee agreed to support this applications.

S.23/0643/HHOLD. S.23/0644/LBC. The Committee agreed to support these applications. Holcombe House. Replacement roofing, reinstate gable entrance, erection of link extensions and internal alterations.

S.23/0654/HHOLD. Ridgewood, Queens Mead. Replacement of existing porch canopy with enclosed porch. The Committee agreed to support this application.

S.23/0532/HHOLD. Southwood, Jacks Green, Sheepscombe. Erection of single storey pitched annexe. The Committee agreed to support this application but wished to have noted its concerns about parking in the general area.

S.23/0708/HHOLD. Chestnut Cottage, The Park. Erection of two storey side & single storey extension. Resubmission of S.20/0342/HHOLD. The Committee agreed to defer consideration of this application until its next meeting.

The meeting closed at 7.30pm.

**PAINSWICK
CURTAINS & BLINDS**

Vicki Moore

Beautiful, quality
curtains, blinds and soft furnishings
Custom made by hand

01452 810707
07810 646714
vickicmoore@gmail.com

PARISH COUNCIL

Present: Cllrs Martin Slinger (Chairman), Andy Cash, Adrian Gyde, Sandra Hunkin, Rob Lewis, Ian Massey, Roey Parker and Abigail Smith.

Apologies: Cllrs Ann Daniels and Rosie Nash. County Councillor Sue Williams had sent her apology but had forwarded a written report.

Also Present: District Councillor Julie Job, six members of the public, one member of the Press and Mr Owen Parry of Gloucestershire Highways.

Broadham Temporary Lights

Mr Owen presented the Parish Council with the details of the proposed Road Safety Improvement Scheme on the A46 at Broadham. (See the report on the front page of this edition). Various questions were asked by Councillors. One issue being the need for a consistent speed limit.

Public Questions

Members of the Painswick Valleys Conservation Society and Painswick Beacon Conservation Trust were present to ask a question about the ownership of land abutting the Painswick Beacon Manorial Land at Golf Course Road. The Parish Council agreed to pursue the matter.

Mr David Allott, present at the meeting, had written to the Parish Council asking whether the Council was aware that significant uptake of the opportunities for FREE assistance with establishing Wildflower Meadows from the Conservation Board team was already happening in Painswick? There were three frontages along Golf Course Road and three more Painswick sites already earmarked, with yet another three under discussion. He asked whether the Councillors could help this scheme either with suggested sites or suggestions for increased effective publicity.

Reports

County Council. Cllr Sue Williams report had been circulated to Councillors previously. Some of the issues in the report were the encouragement for householders to "Recycle electricals". Electricals are rich in precious metals but must be

recycled properly. Confirmation was given that Recycling Centres no longer accept vehicle tyres. As part of the Government's 2023/24 budget, an additional £200 million will be provided for highways maintenance across the country. Gloucestershire has been awarded £3,958,400 of this funding. The Government funding will be in addition to the £100 million that the County Council has already committed to improving the County's roads. Community Meals Service for Stroud. Following Apetito ending their meals service, residents who receive Adult Social Care subsidies will continue to receive support from the County Council. The full report can be accessed on the Parish Council's web site.

District Council. Cllr Job told the Council of the need for more volunteers for the Stroud Community Hub. She said that the Stroud Local Plan was being reviewed. Cllr Job spoke of the need for voters to have photo ID at the polling station. The provision of homes for Ukrainian families was an ongoing issue. Cllr Abigail Smith raised the issue of the reduced bus service. Cllr Job said that issue had been raised with Stroud's MP but all should be aware of the financial constraints on bus companies. Mr Balgobin reported the Council's thanks to Cllr Keith Pearson for negotiating the planning approval for the Woolpack Inn at Slad.

Chairman. Cllr Martin Slinger gave the following report, "Our Council is a very close knit group of diverse people who work together to drive our Parish Council forward with the help of our two Clerks who often have a lot of work to do. We find as Councillors that when talking to the public they wish to ask a question but either they do not know who to speak to or too frightened to do so. Just ask one of the Councillors or find our email addresses on the web site or just phone us. With 4 villages there is a Councillor in each to ask or just get hold of one of the Clerks as well if the Councillor does not know the correct answer he will pass it to the Clerk to fine the information.

B. Pearse Carpentry

" A complete woodworking service "

All internal / external work
Bespoke Joinery supplied and fitted
Staircases, kitchens, wooden flooring
Timber framed buildings / extensions
Traditional cut Roofing
Renovations / Alterations

Ben.pearse@hotmail.com
07791 639 635

**LARWOOD
GARDEN SERVICES**

MOWING AND LAWN CARE
WEEDING, PRUNING AND PLANTING
HEDGE CUTTING AND CLEARANCE
FENCE AND SHED REPAIRS

TRUSTED LOCAL COMPANY, ESTABLISHED 1998.
FOR A FREE ESTIMATE CONTACT NEIL ON:

07816 496087

ENQUIRIES@LARWOOD.NET

We love these beautiful valleys and we are now moving into the time of year when our woods and pastures are coming into flower, some very rare, so please look after what is happening with the birds. Please don't disturb their nests on the ground: so please watch where you step and keep your dogs under control".

Representatives on other bodies
Painswick Community Support Group. Cllr Abigail Smith reported that a Community event is to be held on the Recreation Ground on 8th May.

Painswick Beacon Conservation Trust. Cllr Ian Massey updated the Council on recent events.

Ward reports
 Cllr Andy Cash reported on a recent Ward Meeting and thanked Cllr Smith for her attendance.

Edge Ward Meeting. Cllr Slinger updated the Council on a recent Ward Meeting.

Land and Buildings Committee Meeting
 Town Hall lower room blinds. The Council approved the quotation from Lakeside Blinds with a cost of £1772.

Annual Parish Council Meeting.
 This will be held on Wednesday 17th May at 7.30pm in the Painswick Centre Beacon Hall.

Meeting closure. The meeting closed at 8.42pm.

The Annual Parish Meeting

Wednesday 3rd May 2023

in the Town Hall

between 6 pm and 7.30 pm

Members of the Public are welcome to attend the drop-in meeting. Your chance to meet with the following invited representatives:

- Parish Council – Traffic, Footpaths, Rural Environment and Planning Committees
- Gloucestershire County Councillor Sue Williams
- District Councillors
- Community Police
- Neighbourhood Warden
- Library
- Painswick Beacon Conservation Group
- Cotswold Wardens
- Painswick Community Support Group
- Sportily

M S Slinger
 Chairman of the Parish Council



Coronation Street Parties

The Beacon would welcome photos of any street parties (or other parties) to feature in its June issue. Please send to beacon@painswick.net

Subscriptions

Just a quick update on the current Beacon subscriptions. Of the 1250 copies delivered to our circulation list (Painswick ward, postal, Pitchcombe and Edge), we have received 318 subscription renewals including 69 by Bank Transfer.

Please keep your subscriptions coming.



Gardens & Interiors

www.cotswoldcontemporaryliving.com
 Designed in Painswick 07832 351864

MANN Jewellers
 Established 1741
 8 GEORGE ST, STROUD

GOLD COINS WANTED
 Sovereigns, Krugerrands & Bullion
 bought for cash or instant bank transfer
 We also buy **jewellery & classic watches**

Visit our Stroud shop
01453 764097
 Mention this ad for a free appraisal

We are still an independent family-run business

BRIGHT & BEAUTIFUL
 A BEAUTIFULLY CLEAN HOME AND A BRIGHTER YOU

HOLISTIC HOUSEKEEPING PURE ECO FRIENDLY PRODUCTS
 STRICT SECURITY PROCEDURES TRUSTED TEAMS OF UNIFORMED STAFF

REGULAR CLEANS HOLIDAY LETTING CLEANING DEEP CLEANS

01452 401171
gloucester@brightandbeautifulhome.com

PAINTING & DECORATING

Domestic & Commercial
 Internal & External
 Gloucestershire & Cotswolds
 Based in Painswick
 Detailed quotes
 Fully insured

Call Ken Ticehurst
07808 511066
glospaint.co.uk

CLARICO
 EXTERIOR CLEANING

WINDOW CLEANING
 High reaching water-fed pole system
 (suitable for delicate windows)

SOFFITS, FASCIAS & CLADDING
 GLASS VERANDAS
 CONSERVATORIES & ALIKE
 SOLAR (PV) PANELS

£5 Million Public Liability Insurance

Husband & wife team, Dan & Lois
 "We'll always notify you the day before we're due"

T: 07552 398638
claricoexteriorcleaning@gmail.com
www.claricoexteriorcleaning.co.uk

Beacon Flat Roofing

EPDM & Fibreglass specialists
 New roofs / existing roof replacements and repairs
 Certified installers

Ben.pearse@hotmail.com
07791 639 635

Beauty Spot near Painswick Threatened by Development

We live near Juniper Hill and Frith Wood, which are both Sites of Special Scientific Interest. At the top of Juniper Hill, between these two SSSIs, lies a 20-acre piece of limestone grassland for which the Cotswolds Commons and Beechwoods AONB is famous. This particular wildflower meadow is rich in flora and a product of the geology together with many years of low intensity grazing, and it provides an ecological transition to Juniper Hill, a rich unimproved limestone grassland, to the woodlands immediately bordering it, and also a link to Bull's Cross, Painswick Beacon, Rudge Hill and Swifts Hill, all special wildlife-rich grasslands. The AONB website states that only 1.5% of the Cotswold wildflower meadows remain, and are a priority for conservation, as most ecosystems of this type have now been lost; they are valuable carbon stores, are scarce, and can only be maintained by carefully controlled grazing. The meadow is rich in wildflowers, including five species of orchid, together with many species of pollinating insects and a breeding population of skylarks. Representatives of public bodies and wildlife organisations with knowledge of this site consider it to be an extremely valuable and environmentally sensitive area. It is, however, unprotected at the moment.

After being used as grazing for cattle for many years, this land was purchased by Woodland Investment Management Ltd about two years ago, and recently, work began by dividing the land into 5-acre plots, initially for sale as tree planting land. This has involved quarrying on the site to obtain stone and building a new track across the field for a distance of 500m. Very recently, contractors have been installing fences to mark off the separate plots and restrict public access to a narrow wire-mesh lined path.

It is clear to everyone with an appreciation of landscape and wildlife that this is not an appropriate site for an afforestation scheme. As a site of 20 acres, an Environmental Impact Assessment would need to be undertaken and local stakeholders consulted; in this case it is possible that the subdivision into smaller plots is an attempt to evade this requirement.

After making enquiries with the company, we were told that a



large-scale tree planting scheme is now not planned, but there remain many concerns about how the current richness of biodiversity will be maintained. The changes to the landscape character of the site are obviously detrimental, and the restriction to public access which is asking local residents and other walkers to remain between narrow lines of wire mesh after decades of unrestricted access, has provoked strong feelings. The work already carried out by Woodlands Investment Management Ltd is completely lacking in sensitivity for the nature of the site as well as for the long history of interaction by local residents with the site. The track, lines of fence posts and fenced path are an assault on the landscape value of this open grassland site, and they also disturb the nesting skylarks.

There are concerns that if the plots are sold, not enough will be done to safeguard the current biodiversity and through inappropriate management, there will be a degradation of biodiversity - for example, by inappropriately planting trees, or by mowing too early in the season, or not at all. Further concerns are raised by the track giving vehicle access to the site. The constructed track is substantial, suggesting that vehicle movement could be significant, with an obvious impact on Frith Wood SSSI.



We would like Woodlands Investment Management Ltd to reconsider this ill-advised scheme and find a solution that preserves the biodiversity and landscape value of this unique site, and that keeps it intact. Our concerns are shared by the many local residents we have spoken to. We consider ourselves stakeholders in this landscape and feel that our views should be taken into account.

We would like to ask Beacon readers for support with challenging this development. It seems that the company involved in this development, Woodland Investment Management Ltd., might be able to evade the requirement for an Environmental Impact Assessment, simply by dividing land into smaller plots, and if that is the case, not just Juniper Hill, but many other sensitive ecosystems could be threatened.

Steve Ferguson (07989 396018), Barbara Browne (01452 812219), Joy Elworthy (01452 813823)

Steve Ferguson (07989 396018), Barbara Browne (01452 812219), Joy Elworthy (01452 813823)

LIAM PHIPPS
General Builders & Stone Masons
'The complete building service'
 Extensions, Renovations, New Build
 Carpentry
 Roofing
 Kitchens
Liam: 07540 246133
liam.phipps@hotmail.com

CENTRELINE
 STONEMASONRY
 HISTORIC
 BUILDING
 REPAIRS
 & ALTERATIONS
 01452 813892 OR 07967 316038
 WWW.CENTRELINESTONE.CO.UK
 Fairfax House, Vicarage Street, Painswick, GL6 6XS

ALL STONEMASONRY LTD
 EXPERTS IN STONE
 Drystone Walling; new and restoration
 Stone repointing; including lime mortar
 Mullion Windows Restored
 Any stone repaired or replaced
 Local masons with 40 years experience
01452 728949
alan@allstonemasons.com
 For Your Quotation / Advice



New Friendship Signs

Following on from the signing of a Friendship and Co-operation Agreement (FCA) between Painswick Parish Council and Slavutyich, Ukraine, the Council agreed to place signs on the main roads into Painswick. The signs are a small but clear step towards establishing a long-term relationship between the parish of Painswick and Slavutyich.



The photographs were sent to our contact in Slavutyich who responded with this message:

“Thank you very much for this extraordinary event and the decision to place this signage in Painswick. It is very beautiful and really inspires us here in Slavutyich, in Ukraine, to fight for our victory! Very grateful! All Slavutyichers will be delighted. Thank you, Painswick.”

Would you like a penfriend?

Our friends in Slavutyich, Ukraine, have a number of people (adults) interested in being penfriends with someone from Painswick. Might you be interested?

For the Ukrainians, this will help them to practice their English, learn about the English way of life, and feel supported during the war. For Painswickians, it will give you a personal insight into life in a very interesting place, and, sadly, a very ‘interesting’ time. And, hopefully, make a friend.

It is expected that communication will be in English (no need for you to learn Ukrainian!) and can be by either letter or email. The frequency and what you write about will be entirely up to you and your penfriend.

Interested? Contact pippadickinson4@gmail.com with a couple of lines about yourself and whether you would prefer to email or write letters.

Volunteers needed!

Citizens Advice Stroud and Cotswold Districts needs volunteers now more than ever to help make a difference to local people. In the last year we have faced an unprecedented demand due to the cost of living crisis.



We are appealing for new volunteers from all backgrounds who are looking for a volunteering role that is both challenging and rewarding. We are looking for people who can give 8-10 hours per week and are currently recruiting for the following roles:

Administration/triage assistants

You will provide a professional welcome to callers at the door of our Stroud or Cirencester offices. You will triage callers without an appointment - identifying emergencies and providing information and signposting to other agencies when needed (no advice giving involved). You will also undertake a wide range of administrative tasks, including contacting clients by telephone and text, and handling inward and outbound post. You must be computer literate but full training in triage and our IT systems will be given.

Volunteer Advisers

You will give advice and information (face to face, by telephone and email) to clients on a wide range of problems. No prior advice experience is necessary as full training will be given. Information sessions for volunteer advisers will take place on 24th May 2023 (2-3.30pm) in Stroud and on 7th June 2023 (10.30-12 noon) in Cirencester.

To find out more about these roles or register your interest for a volunteer adviser information session please contact our Learning and Development Officer at training@ca-scd.org.uk. You can also find further information on our website www.citizensadvice-stroudandcotswold.org.uk.

Now more than ever, you can really make a difference by volunteering with us. We’re seeing more and more people needing support as living costs spiral. As well as helping the local community, we know people who volunteer their time get a lot back. We’ll give you all the training you need and would love to hear from you.

Peter Rowe

Dr Hauschka Organic Facials

Your friends will ask enviously if you've "had work done..." But you'll smile secretively, knowing you look great, naturally.

Book yourself a Dr Hauschka treatment with **The Organic Beautician** and treat your skin to the visible difference

text 07961 224560
jane@theorganicbeautician.com

Mention this ad when booking for a free Cleansing Cream
 Based in Pitchcombe since 2007

painswick osteopaths

Paul Stamp D.O. Helen Froggatt D.O.

Tel: 01452 301748

- Structural
- Cranial Osteopathy
- Sports Injury
- Neck, Shoulder, Hip, Knee

Parking Available

Landcare Services

Environmentally Sensitive
Tree Surgery

All Types of Tree Work Undertaken
 Contact Zeb or Clare on

Phone 01452 812709
 or 07969 918121
Clareoverhill@phonecoop.coop
WWW.Treesandlandcare.co.uk

Historic May Crimes



1863 Charles Fisher, a green grocer of Painswick, was summoned for assaulting his wife. The case showed great faults on both sides. Defendant was fined 2/6 and 9/- costs. *Gloucester Journal*

Job Swayne and William Stephens, each fined 2/6 and 2/- costs for being disorderly in the beer house of William Compton. *Gloucester Journal*

1873 James Cook and George Hanks, mill boys, were charged with having unlawfully and wilfully attempted to take otherwise than by angling, to wit, by using eight fixed fishing lines, certain fish, to wit, trout, then being in certain water in which James Gardner had a private right of fishery. They pleaded guilty. There were previous convictions with regard to both lads, and Cook bore a bad character, and each was fined 7/6. *Stroud Journal*

George Powell, aged 12, was charged on remand with stealing 3/-, the monies of his master, Mr Thomas Hart, a chemist of Painswick. On the date in question he [Thomas Hart] left the shop and when he returned he looked at the till having suspected the prisoner. He found that some money was gone. His son charged the prisoner with taking the money, and then the prisoner took 3/- out of his pocket and said it was all he had taken. The boy pleaded guilty and there being no previous convictions he was sentenced to ten days imprisonment. *Stroud Journal*

Thomas Mills, a servant, charged with assaulting and beating Samuel Webb, a dealer in cattle. [There follows a long explanation of how Mills was threatening and fighting another young man and when Webb remonstrated with him he turned round and said "I'll serve thee the same" and struck him on the back of the neck, then followed him and punched him in the face.] Defendant was the worse for drink. Fined 1/- and 16/- costs. *Stroud Journal*

1903 George Gunston, mill hand, was ordered to pay 1/6 a week towards the maintenance of his mother, Caroline Gunston; and David and Arthur Gunston, other sons, were also ordered to contribute 1/6 a week respectively. *Gloucestershire Echo*

William Swayne was summoned for having threatened to smash the head of William Organ. Complainant stated that he was going down a lane at Painswick when he met defendant who threw off his coat and said, "I'll smash your head in." Witness was alone, but defendant made no attempt to strike him. The Bench were of the opinion that the threat was an idle one as no attempt to strike complainant was made. They dismissed the case. *Stroud News*

1923 Eight youths from Painswick were summoned for stealing five gallons of cider to the value of 5/-, the property of Henry Edwards of Jenkins Farm. The cider was stored in a shed, securely locked up. He found the door had been forced and five gallons of cider taken from a cask. Defendants admitted having entered the shed and drank the cider or taken some away in bottles. They were each fined 10/- with 1/- each for the cider stolen and damage done.

Carol Maxwell

Painswick Community Support

Preserves

Once again this summer, if anyone has excess fruits such as blackcurrants, plums and damsons, Painswick Community Support would be very grateful for donations.

Preserves will be offered during Friday Hub at the Town Hall. If anyone is able to help with preserving some of the donated fruits (even just one batch), we would be really grateful; this way we can offer more. We can provide volunteers with preserving materials such as sugars and jars and we can drop off donated fruits to you. Thank you to everyone who has donated empty jars; we have plenty now and do not require any more for now.

Delyth Allen

On behalf of Painswick Community Support





**STEPWISE
FOOT CARE**

Mobile service

Call Elisabeth B.Sc, FHP
07387 822770

Chloe McCarthy BTEC Nail Dip



Revive Beauty
Chloe McCarthy
Tel: 07859 880641
revivepainswick@gmail.com

Painswick Beauty Room Three Gables Centre Cheltenham Rd	Cranham Village Studio * New Location *
Tues 9.30 am - 7 pm Wed 10 am - 2.30 pm	Thurs 9.30am - 6pm Fri 9.30am - 2.30pm

www.revivepainswick.co.uk
With eighteen years experience



Anne-Marie Randall
PHOTOGRAPHY

www.amrandall.com / 07815082209

COTSWOLD EVENT STAFF

Friendly, hand-picked and trained
Waitresses, Waiters, Bar staff and Cooks



For all your events
big and small

**Parties
Weddings
Funerals**

Contact: Sarah Murray 07870 967 359
Cotswoldeventstaff@gmail.com

Painswick's new traffic cameras

Questions for Abigail Smith, Chairman of the Traffic Committee

In recent months, the Beacon has reported on Parish Council plans to buy three Automatic Number Plate Recognition (ANPR) cameras to be used in Painswick. These small cameras are spreading fast across the country, often used to record the entry and exit to car parks, but also more widely on roads and on private premises.



We are often barely aware of them, but they are silently recording our data. Are they a hidden spy, threatening our civil liberties, or a vital tool to protect our safety? We asked Abigail Smith, chairman of the Parish Council's Traffic Committee, a series of questions on how and why the cameras will be used in Painswick. Her answers are below:

1. Why do we need 3 ANPR cameras in Painswick?

Abigail Smith: The cameras are very cost efficient and we were given one for free under the County Council Community Speed Watch initiative. We have 3 key entrance points into the centre of Painswick so it was easily affordable within our allocated traffic budget to purchase a further 2 cameras. Further, having 3 gives us flexibility to spread them around the Parish as other sites are approved by the police (e.g. Edge have already sites approved).

2. What data will they record and keep?

AS: They will record vehicle speed and registration numbers of vehicles exceeding the speed limit.

3. What will happen to the data then?

AS: Once a week, Parish Council will provide the top ten speeding vehicles to the police who will send out warning letters to the registered owner of the vehicle. The police will use the data to support enforcement action within the Parish, as they deem required. Please note that Parish Council do not have the required clearance to identify the owners of the vehicles from the registration so no personal data will be held by the Parish Council.

4. Will fixed penalty notices be issued?

AS: No.

5. Will there be clear signage of the cameras?

AS: Yes - signage of their presence is a key part of the initiative. These will be placed at key access points to the village so drivers are warned that they need to watch their speed as they travel through.

6. Will there be any display to indicate that you are over the speed limit and that your data is being recorded?

AS: No. The cameras are very small, only aimed at recording data.

7. Where will the cameras be positioned?

AS: They are only positioned at police-approved sites. As noted above we have several approved in Painswick and Edge. Signage on the entrance points indicates their presence within the villages, but I am not going to publish exact locations given that defeats the objective of the exercise and will encourage people to speed up between them.

8. When will the new cameras be put up?

AS: We will only put them up in conjunction with the signs. We are awaiting arrival of the signs.

9. Will the current electronic speed warning signs remain in place as well?

AS: Yes - these are a key part of raising awareness of speed to drivers on the A46.

Resthaven offers 24 hour residential and nursing care set amidst some of the finest countryside in Gloucestershire with panoramic views over the Painswick valley.

For more information please call 01452 812682 or, visit: www.lillianfaithfull.co.uk/resthaven

Resthaven is part of the charity Lillian Faithfull Care
Registered Charity No: 1122183

LILIAN FAITHFULL CARE

Library Book Club



Our next meeting is on Monday 22nd May at 1.30 - 2.30pm. We will be discussing Lessons by Ian McEwan. The following month we will meet on 19th June, again 1.30 - 2.30pm and we will be discussing Miss Benson's Beetle by Rachel Joyce. She is the best-selling author of The Unlikely Pilgrimage of Harold Fry. If you haven't joined us yet but would like to, please come along to one or both meetings. Everyone is welcome. For further information email painswick.library.bookclub@gmail.com

Pat Andrew.

Joined Up Thinking for Local Nature

Free event, Painswick Town Hall, Tuesday, 16th May, 7 pm.

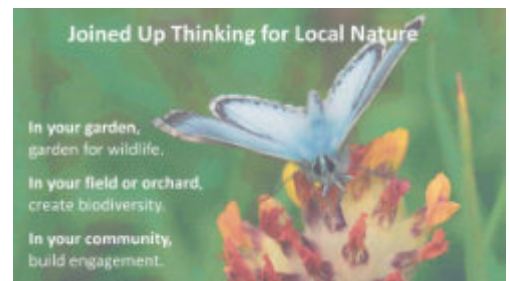

Painswick Beacon Conservation Group (PBCG) and Wild Stroud are organising a free event in the Painswick Town Hall on Tuesday 16th May, starting at 7 pm. There will be a talk explaining the National Trust's Stroud Landscape Project followed by a talk about the local wildlife corridors being created by Gloucestershire Wildlife Trust. There will then be suggestions of what we could do to improve our land, orchards and community spaces for wildlife. Wild Stroud is working on the urban side of this project. These talks will be followed by a Q & A session.

Joyce Barrus

opens from Sat: weekdays, Sat: Sat, 10am-5pm
Coffee / Clothing / Gifts
meadows-store.com

meadows
ST MARY'S ST
GLS GQG
ALLPRESS
ESPRESSO

MEADOWS PAINSWICK

Alex Nichols - 1929-2023

Alex, a well loved Honorary Life President of PMAG, passed away in hospital on the 31st March 2023, aged 93.

Duccio Leoni, a long time member, wrote an affectionate letter of condolence to his family. In doing so he spoke for so many who were fortunate to know Alex.

Duccio wrote:

'I remember when Leslie Brotherton told our small group of classical music lovers that he had managed to convince Alex to become a member – and that was nearly 30 years ago. He was to become a major presence in the club once Leslie, Harold Wood and Ralph Kember decided to offer him the chairmanship. This role he embraced with vigour and during his lengthy period as chairman he introduced the membership to the finer nuances of the orchestra and the voices of the world's finest singers.

Central to his depth of immense musical knowledge was his love of opera and not least, the works of Verdi.

I shall miss his booming voice, his tales of travel around the European theatres to attend operatic performances and his pleasure in acquiring rare recordings. He was such a personality that even in his later years he was still in the thick of enjoying debate on musical and related topics.'

Alex was a person of immense energy and influence as chairman of PMAG for over 20 years. He was the heartbeat of the club and essential to its continued progress. He will be much missed by the membership.

Howard Allen. Past Chairman.



Road Closures

St Marys Street

St Marys Street is to be closed from its junction with Friday Street to its junction with Vicarage Street for a distance of approximately 55 metres to allow a safe working zone during electrical works.

The road is expected to be closed from 09:00 on 15th May 2023 until 18:00 on 18th May 2023 only or until the works have been completed. For further information, please contact Gloucestershire Highways on 08000 514 514 or visit www.gloucestershire.gov.uk.

Pedestrian access will not be permitted for safety reasons. Emergency access will be maintained.

Vicarage Street

During the period of a Coronation Street Party on Sunday 7th May Vicarage Street will be closed from 10 am to 10pm between White Horse Lane and Beech Lane. Both lanes will be accessible from each respective end.

Other streets in the village may also be closed for similar events but the Beacon has been unable to confirm this.

The joys of spring

After a busy Easter for us, the joys of May are upon us. This is when the Garden really gets going. Horticulturally there's so much happening! Visiting is Wednesday to Sunday, 10am-5pm. This year, May is blessed with extra Bank Holidays and we are open for all three, plus the whole week of May half term. No advance booking is needed but it is useful if you want to guarantee admission on a busy day. It's one of the best times to see new life, with seedlings taking off in the Kitchen Garden and leaves bursting out on the trees.



Our ever popular summer outdoor shows are selling really well. We start the season with an improvised whodunnit, LocoMotive for Murder on Friday 2nd June, in which the audience will help solve the crime! Next in the diary is the annual visit from the Handlebards who travel the length of the country by bike, performing Shakespeare. They will be bringing us "A Midsummer Night's Dream" on 30th June and 1st July. For more detail about these and our other performances, visit rococogarden.org.uk/whats-on.

With warmer evenings on the cards, we've been working on a brand new cider in partnership with Slad Valley Cider. Using apples grown in the Garden (the half which didn't go to make our ever-popular apple juice), this 5% ABV brew has been through testing and tasting and will be on sale in our Shop shortly. We think it's likely to be a hit!

Spring is a really busy time for our onsite partners here at Exedra Nursery. It's a relationship that we value and works really well. Don't forget they are your local provider of top quality plants at very competitive prices. Add to that easy parking and friendly advice dispensed – I don't think you will find a better source for all your garden needs. Come and meet Steve and Julie here Tuesday to Sunday 10am-4pm.

That's our Rococo news for this month. With the first proper warmth in our sheltered hidden valley, this is the perfect time to leave your cares in the car park and enter another world.

Tim Toghil, volunteer

Computer or Tablet Problem?

Computer repairs & upgrades
6 month health check ups
Plain speaking tuition
Internet security
Remote support
Wi-Fi solutions
Easy backup
Hints & tips
Advice
Help

★★★★★
5 star rating

Matt Hughes
07740 167318
www.pcprop.com
£45 ph Est.2003



Cherry Tree Glamping

Four beautiful and fully-equipped lodges, each with a hot tub on the veranda.
Adjacent 2 acre campsite with 19 electric hook-up points and huge communal area.
Available individually or either site exclusively for weddings, special birthdays or family get togethers. Showers and toilets.

Please call Bev: 07717 721213
www.cherrytreeglamping.co.uk
Sunflower Cafe:
Tuesday-Sunday 07341 903745

Fabulous View

Window Cleaning and Dry Stone Walling in the Cotswolds

Window Cleaning up to 40ft
Sky lights and Glass Roofs
Orangery Cleaning
Leaded glass
Gutter Clearances & Dry Stone Walling



A great reputation in Painswick and surrounding villages since 2004. Fully insured.

Call Philip Lines today for a quote: 07722 003302

Visit us at www.fabulousview.co.uk

News from St Marys

May promises to be a very active month with the Coronation of King Charles III on the first weekend and several Christian festivals following. Then there will also be three Bank holidays! The main service in the benefice on 7th May will be at Pitchcombe Church at 11am led by Revd Andrew. Other services will be held at Sheepscombe and Cranham again starting at 11am.



There are three Rogation Days preceding Ascension Day. Rogation Days are associated with 'beating the bounds' when traditionally the Vicar walked around the parish boundary asking for God's blessing on the growing crops.

In the middle of the month we have Christian Aid Week running from 14th to 20th May. During the week there will be a house to house collection and various other fund raising events centred at the Church Rooms. On Tuesday 16th May there will be a salmon supper priced at £20. Tickets – phone 812966 or 810925. The Christian Aid shop will be open on Friday 19th and Saturday 20th --- bring and buy garden shop, ploughman's lunches (12 to 2) and cream teas (12 to 4)

Ascension Day is on Thursday 18th May. This is the day when we remember Christ's Ascension to Heaven following his earthly ministry and resurrection. There will be a benefice service on Ascension Day at Edge Church at 6.30pm led by Revd. Sarah.

Ascension Day is followed by Pentecost also known as Whit Sunday. This is the day when we celebrate the coming of the Holy Spirit to the twelve Apostles. The Holy Spirit is the third person of the Trinity and following His coming to the Apostles is now a gift to the whole church. We think of the Holy Spirit as God with us, God alongside us. The main service at St Mary's on Whit Sunday will be Beacon Praise at 10am led by Revds Sarah and Paul.

David Newell

Mediaeval Market Towns

At our April meeting Nicholas Herbert gave us a fascinating insight into the development of the mediaeval market towns of Gloucestershire. These are predominately the smaller towns created in the 12th and 13th Centuries. The larger towns of Gloucester, Tewkesbury and Cirencester have their origins in earlier Saxon and Roman periods.

Nicholas began by posing the question of what makes a town and this was essentially that it had a different relationship with the local 'manor' in its form of governance, taxes and property ownership than that of surrounding villages and countryside; town and borough courts would replace the old manor courts. In addition these towns were places of trade and craftspeople.

Typically Gloucestershire market towns were founded on the site of an existing village and Northleach was given as an example. With its long trading street and burgage plots (100 yds by 16/17 yds). In later years these original plots were sub-divided and in 1551 there were ½ and even ¼ burgage plots. On the other hand as Northleach became prosperous during the later middle ages through the wool trade wealthy inhabitants bought up and amalgamated plots - the Midwinters having a site of 3½ burgage plots.

Details of how these promoted villages were governed is thin on the ground as few founding charters remain and even the surviving ones often only referred back to an earlier charter of another town for example Thornbury simply refers back to Tewkesbury's charter. There are more extant Charters for the setting up of weekly markets and annual fairs. A grant was required from the King to set up a market - essentially it was a way for the king to raise money!

Various clusters of market towns arose but in the end only one or two would survive, thinned out by the economics of trade. The survivors some 25 or 26 in Gloucestershire with each single town typically serving around 12 villages. Painswick notably one of the survivors received its market charter in 1253 and its market continued into Victorian times with the surrounding villages Edge, Sheepscombe, Slad, Uplands... remaining under the manorship.

A wonderful talk full of insight and detail was enjoyed by all. Our next meeting is our annual outing, this year to Woodchester Mansion on Tuesday 23rd May. Those going need to be at the National Trust car park by 2.15m at the latest.

Peter Jackson

Jottings

The Beefly.

As I was walking down our path the other morning I came across three Beeflies (they are harmless to man). There are twelve species of British Beeflies. They are two winged with furry bodies. They look like bees and fly like them even hovering. They feed from flowers with their tubular mouth parts the proboscis sticking straight out in front of the head even when feeding.



They have four stages of their life cycle, egg, larva, pupa and adult. In some species the female collects a dusting of sand on her tail tip and uses it to coat the eggs to stop them drying out. She hovers above the burrow of a Solitary bee laying her egg close to it. When the larva hatches it crawls into the hole the Solitary bee has dug for her egg. The beefly larva and the solitary bee larva live happily together feeding on the food stored by the Solitary bee. Eventually the Beefly larva eats the Solitary bee larva and remains in the burrow pupating and hatching to produce an adult beefly.

Cows and Methane

We all know that cows are very good at producing methane. They have four stomachs, the first, the rumen acts as a big fermentation vat breaking down tough plant material. This produces the methane which is burped out. Some strains of cattle naturally produce less methane so they are being selectively bred. It is now known that if there are certain bacteria present in the rumen, less methane is produced. So products are being developed (with these bacteria) which could suppress methane production, but they are waiting for approval. Just changing their diet can also lead to less methane: Such as a diet rich in maize, barley or even garlic. Another way is to plant more legumes, such as clovers, that absorb greenhouse gases and lock them into the soil. However, methane lasts only for about a decade in the atmosphere, while carbon dioxide persists for centuries.

Martin Slinger

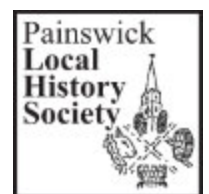

Painswick Music Appreciation Group



The 13th April event began with a sad introduction from the Chairman marking the loss of the lifelong Honorary President Alex Nichols who had passed away on the 31st March in his 95th year. He had founded and mentored PMAG for some 30 years and in his memory some of his beloved Verdi was heard. [See obituary on page 8]

On 30th March Reg Wrathmell offered a selection entitled 'A treasure trove of neglected gems for soloists and orchestra'. Largely drawn from less obvious composers of the romantic era, Messrs Scriabin, Bruch, Berlioz and Paderewski showcased the piano, the cello, the viola and as if to put them in perspective he included a master, Beethoven, who's Triple Concerto for violin, cello and piano stemmed from earlier more classical times. A very melodious and informative afternoon.

On 13th April Messrs Kerton and Richardson presented 'Brass Bands'. A peculiarly British (and to a lesser extent American) phenomenon they originated in the early and mid 1800s founded by heavy industrial corporations perhaps to decrease the possibilities of political activity of working class employees by filling their leisure time. Some have survived and outlived their foundations and such household names as Black Dyke Mills, Grimethorpe Colliery and Fodens amongst others have continued often rebadging where companies have ceased trading or been taken over. The range of music is extraordinarily wide from classical transcriptions, show tunes, popular music to original compositions usually scored for around 30 brass and percussion players in amazing arrangements. A rousing afternoon.

The last event of the PMAG season in the Town Hall will be on the 11th May 2023 7:30 (please note the time)

Michael Grey

Easter Party

Painswick Art Club had an Easter Party on Tuesday 11th April with a Clay Workshop. In fact the occasion was in lieu of the planned Christmas Party which had to be cancelled because of the snow fall we had just before Christmas. Vicky joined us with plenty of easily workable clay, vibrant paint colours and tools for making pots. She took them to be fired in her kiln and will be returning our creations in a couple of weeks. We were totally absorbed, moulding the clay, a very therapeutic process. We then shared lunch contributions and mulled wine or soft drinks.

Joyce Barrus



GROUNDWORKS - DRAINAGE
EQUESTRIAN WORKS
LAKES - PONDS - WATER FEATURES
FENCING - DECKING - HEDGING
DRIVEWAYS - PATIOS
TRADITIONAL BUILDING WORK
ALL PASSIONATELY UNDERTAKEN

PLEASE CONTACT
BEN LIVING
01452 812036
07702 984711
enquiries@blc.uk.com
www.blc.uk.com

GROUNDWORKS
LANDSCAPING
BLC
BUILDING
PROFESSIONALS

 **three gables**
dental, holistic + beauty centre

- ▷ PREVENTATIVE AND COSMETIC DENTISTRY
- ▷ BEAUTY/FACIAL REJUVENATION
- ▷ STEPPING-STONES OSTEOPATHY

All in a relaxed and friendly environment with early, late and Saturday appointments available. On-site parking also available.

LET US BRIGHTEN UP YOUR SMILE

cheltenham rd painswick glos GL6 6XN
01452 814427
www.thethreegables.co.uk

GYDE ALMSHOUSES CHARITY
REGISTERED Charity Number 201098

A Vacancy has Arisen for An Almshouse at GYDE Road Painswick
Applicants must be over the age of 55 with a local connection

For further information on how to qualify and to receive an application form

Please Contact
Mrs S Baker - Clerk to the Trustees
14 Green Close, Uley,
Dursley, Glos, GL11 5TH
Tele: 01453 860379
Email: shanibaker7@gmail.com

Closing Date for Applications:
20 May 2023

Friday Club

After a wet Easter break the Club held a special Tea Party on the 14th April to launch its Spring Programme. Joyce Barrus, Chairman, followed up on several points brought up at our AgeUK talk last month. Certain Opticians in Stroud can help with sight and hearing issues, and will do home visits. People who do not drive can still receive a Blue Badge which belongs to them and can be used if a friend or relative drives them somewhere. Joyce had also attended a recent library talk on dementia and how to help friends and relatives. Jane Rowe followed on with practical advice on how to claim for an "Attendance Allowance," which was of great interest to many Members.



Yours truly had organised a quiz which Members found easy to answer! But there were a couple of trick questions to test them! This was followed by the serving of a splendid tea consisting of sandwiches, cakes, jelly and cream. A very enjoyable time was had by all. Many thanks to the Committee who not only prepared all the food but also served it to Members.

On the 12th May we will welcome a Speaker from the "Wild Hogs Hedgehog Rescue Society." We will hear what steps the Society takes to care for rescued Hedgehogs and what help members of the public can offer. Chicken flavoured cat food would be gratefully received by hedgehogs.

Then on the 26th May we have arranged an outing to the Wetlands Reserve at Slimbridge. Not only will we be able to see flocks of Ducks, Swans and Geese and hopefully rare Kingfishers but we will tour, on a special bus, areas not normally open to public. A memorable day!

We will be delighted to welcome YOU on a Friday afternoon. We meet fortnightly in the downstairs room in the Town Hall at 2.30pm on alternate Fridays. Our current programme is published on the Notice Board outside the Town Hall.



Friday Club Easter Party

Mike Kerton

A home from home

"No posters, clocks or uniforms; a calm, light, airy space - a home from home". This is how Andrea Reid described The Maggie's Cancer Centre in Cheltenham to the ladies of Yew Trees WI at their April meeting.



When Maggie Keswick Jencks, a writer and garden designer from Edinburgh was diagnosed with cancer, she and her husband Charles felt there was a sad lack of support for them both, and determined that others should not suffer the same fate. Enlisting the help of friends from the architectural world they designed the blueprint of centres, the aim of which is to make the experience of cancer more manageable. Maggie died shortly before the first centre opened in Edinburgh in 1996 but her vision has lived on. There are now 26 completed centres, and more being built.

Each building is unique but must be in close proximity to an NHS cancer centre. It must feel like a home-from-home offering support to family, friends and carers for as long as needed. A kitchen table, where everyone is welcome to make themselves a drink and sit round and chat is another essential, as is the support of a small team of professional and experienced staff who offer psychological and emotional support as required. Maggie's in Cheltenham, built in 2010, is a fusion of old and new: a lovingly restored Grade 2 listed Victorian lodge with modern extensions and a landscaped garden; all designed to calm, soothe and inspire. Here professional support for anything from treatment and side effects to money worries is free. No appointments or referrals needed. How fortunate we are to have such a wonderful resource close by.

Yew Tree members are celebrating the Coronation by selling cream teas in the Church Rooms from 2.30-4.30pm on Monday 8th May - do come along.

"A Ride Around England" is the title of the talk at our next meeting when William Raddaway will describe his seven month horse ride to the 4 corners of England, including visits to 30 cathedrals. Tuesday 23rd May 7.30 pm in the Church Rooms.

Celia Lougher 812624

PAUL A MORRIS
General Builder Ltd
 Extension: Renovation: Stonework
 Kitchens: Bathrooms: Patios
 Dry-Stone Walling: Plumbing: Plastering
 Over 25 years experience

paulmorrisbuilderltd@gmail.com
www.paulmorrisgeneralbuilding.co.uk
 01452 814524 or 07818 087375

GODDARD'S GARAGE
 Cheltenham Road, Painswick

- * Full servicing & repair facilities
- * MOT preparation & repairs
- * Private hire - taxi
- * Petrol / Diesel / Tyres / Exhausts
- * Paraffin / Coal / Calor Gas
- * Car valeting
- * Air conditioning

Personal attention for your car
01452 812240
goddards.garage@hotmail.co.uk

Michael Gamble
Funeral Directors

Proudly serving the local community since 2008

- 24-hour service
- Bereavement advice
- Transparent pricing
- Private chapel of rest
- Floral tributes
- Memorial masonry
- Home visits
- Prepaid funeral plans

Stonehouse
01453 802 685
 80 High Street
 GL10 2VA

Stroud
01453 790 900
 Station House, Station Road
 GL10 3AR

Call us for immediate support, advice or to arrange a home visit. We are here to help 24 hours a day.

www.michaelgamble.net

District Council By-Election 17th May 2023

Subsequent to the resignation of Jason Bullingham as our District Councillor a by-election has been called to fill the vacancy. The Beacon has asked each of the candidates to give a short profile of themselves which are produced below.

In addition this election is the first in Painswick where the new regulations for voter identification will come into force and you will need to bring photographic identification when you come to vote.



Roz Savage - Liberal Democrat

I'm surprised to find myself standing for election. Politics wasn't a big thing in my family or my circle of friends, and other than voting in general elections I didn't pay much attention.

Twenty years ago I woke up to our ecological crisis and became a campaigner, rowing solo across the Atlantic, Pacific and Indian Oceans to raise awareness of our environmental issues via blogs, podcasts, talks and books. I identified as a campaigner, but not a politician.

My latest book, [The Ocean in a Drop](#), explains how our environmental issues are inextricably interwoven with economics and politics, so we have to take an integrated approach to change. But even then my future path didn't become obvious.

It was on the day of the Queen's funeral, when I was reflecting on her life of tireless devotion to public duty, that the idea to enter politics took hold of me and wouldn't let go.

So why should you vote for me?

I commit to listen when you tell me what our community needs.

I commit to put all my energy into our community's wellbeing.

I commit to serving your best interests.

As a Liberal Democrat, my watchwords will always be:

Commitment - Community - Competence

Gary Luff - Green Party



Your Green Party candidate for the by-election is Gary Luff, who has lived in the village with his wife and two children for 15 years. After a long career in insurance, Gary now runs a community organisation that provides free financial education.

Gary has a strong chance of winning, after the Greens came a close second to the Conservatives at the last election in Painswick & Upton.

Gary predicts that the Tories' share of the vote will continue to decline; local residents have increasingly socially and environmentally aware views, while the Tory party has drifted away from compassionate conservatism.

"Many longstanding Conservatives are questioning whether the Tory party represents their views and values," says Gary. "For them, the Greens offer the most attractive alternative."

Residents say their key concerns are the cost-of-living crisis, protection of the countryside, and climate change – all issues that are close to Gary's heart.

If elected, he will press the County Council to fund rural bus services properly and will campaign for more affordable housing for local people.

"Residents are ready for a change; they want politicians who are caring as well as competent," he says. "I'll work hard to provide the representation that residents deserve."

Ela Pathak-Sen - Labour



I want to be the Labour councillor for Painswick and Upton to help create a fairer society. Stroud Council has an important role to play in combating the pressures that people are undergoing, whether as a result of the pandemic, the cost-of-living crisis, or the difficulty in accessing services, particularly in rural areas where bus services are being reduced.

We have suffered the consequences of years of austerity, the gradual degradation of our services and the growing recognition that nothing works as it should. I want to play my part in putting that right.

I have lived in Painswick for more than 20 years; during that time I have been both a school governor and a parish councillor.

I worked in the NHS for more than 30 years, recently in senior leadership positions; my last post was as a Director for a London NHS Foundation Trust, where I had responsibility for teams that delivered both health and social care. I know first-hand what lack of investment means for us. I am committed to pursuing an agenda that puts environmental sustainability, housing, & transport at the centre whilst not losing sight of the business and job opportunities our beautiful towns, villages and countryside bring.

Sue Williams - Conservative

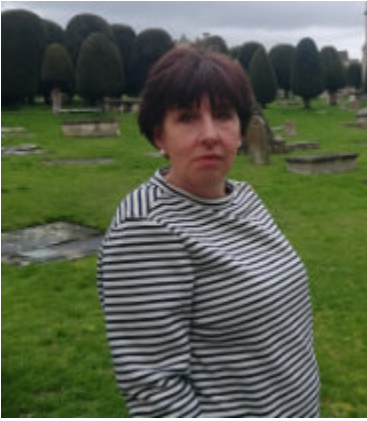

My name is Sue Williams. I have been married to Martin, (an arable farmer) for 34yrs. We live in Bisley, but I grew up in neighbouring Cranham and have had a life- long association with Painswick. My career as a mental health nurse started with my training at Coney Hill and specialised in old age psychiatry for 35yrs before retiring in 2018.

It was a great honour to be elected as your County Councillor in 2021 and I work hard on your behalf. Becoming County councillor gave me the opportunity to serve the community in a different role. Whether that is being the voice/advocate of the parishes at county council level, supporting local projects in the area through County Councillor funding and working on specific council committees such as Environmental scrutiny, and Rights of Way or tasks groups such, restoring our Rivers .

I am delighted to be standing as a candidate in the District Councillor elections . Working closely with District / County Council for a safer, greener and thriving community I will continue to work hard on your behalf. When I am not doing Council Work you will find in my vegetable garden or with my bees .

Requirement for Voter Identification

From May 2023, electors will be required to show an acceptable form of photographic identification in order to receive their ballot paper(s) to cast their vote in a polling station under the new requirements under the Elections Act 2022.

If you don't already have any of the below acceptable forms of photographic ID, you will be able to apply either in person, by post or online for a Voter Authority Certificate (VAC) - a free photographic identification document used and issued for the specific purpose to allow an elector to vote in the polling station.

What photographic ID will be accepted in polling stations?

- Passport issued by the UK, any of the Channel Islands, the Isle of Man, a British Overseas Territory, an EEA state, or a Commonwealth Country
- A driving licence issued by the UK, any of the Channel Islands, the Isle of Man or an EEA state
- A biometric immigration document
- An identity card bearing the Proof of Age Standards Scheme hologram (a PASS card)
- A Ministry of Defence Form 90 (Defence Identity Card)
- A Blue Badge
- A national identity card issued by an EEA state
- An Older Person's Bus Pass
- A Disabled Person's Bus Pass
- An Oyster 60+ Card
- A Freedom Pass

Where an elector does not hold one of the acceptable forms of photographic ID listed above, they can apply for a Voter Authority Certificate free of charge following verification of an applicants identity.

An elector can apply for a Voter Authority Certificate in a number of ways:

- Online on Gov.uk
- Completing a paper application with a photo enclosed
- In person at the Council Offices

PAINSWICK & UPTON DISTRICT BY-ELECTION
WEDNESDAY 17 MAY 2023

Registration Deadline - Midnight, Thursday 27 April 2023
 Postal Deadline - 5pm, Friday 28 April 2023
 Proxy Deadline - 5pm, Tuesday 9 May 2023

In order to vote at the polling station you will need to bring an accepted photo ID with you.

If you do not have photo ID, you can apply for a free Voter Authority Certificate. The deadline to apply is **5pm TUESDAY 9 MAY 2023**

REMEMBER, I NEED PHOTO ID TO VOTE!

Online - www.gov.uk/apply-for-photo-id-voter-authority-certificate
 Post - Download an application form from the Stroud District Council website
 In Person - Call 01453 766321 to book an appointment to come to the Council Offices at Elvey Mill

STROUD DISTRICT COUNCIL
 Call: 01453 766321
 Email: elections@stroud.gov.uk
 Web: www.stroud.gov.uk/elections

Sarah Edmonds Marketing
www.sarahedmonds-marketing.com

Friendly & Professional Freelance
 Marketing - Copywriting - Proofreading
 Personal Assistant - Administration

Ad-hoc, term-time & project based
 15 years + experience, accredited & reliable

Get in touch to discuss your ideas
 Sarah Edmonds 07990 587 967 Painswick resident
sarah@sarahedmonds-marketing.com

Exedra Nursery
 PAINSWICK | GLOUCESTERSHIRE

- Perennials grown on site
- Peat free plants and composts
- David Austin Roses
- Shrubs, alpines, herbs and more
- Gardening gifts and accessories

Painswick Rococo Garden
 Stroud GL6 6TH
 Tel 07487 537026

Open Tues - Sun
 10am to 4pm
www.exedranursery.co.uk

Cotswold Animal Services

Home environment doggy day care and boarding based in Painswick.
 Group socialisation dog walks or 1-1's.
 Equine care and cat sitting in your home.

+44 (0) 7814 955975
www.cotswoldanimalservices.co.uk

P.L. ALLARD
BUILDING & ROOFING LTD.
 Specialists in Period & Modern Property

- Cotswold Stone Tiling
- Natural Slate
- Woodstoves
- Guttering & Leadworks
- Interior Renovation
- Bathrooms & Kitchens
- Chimney Repairs
- General Building

T. 01452 814278 M. 07841 695705
www.allardbuilders.com p.allardbuilders@gmail.com

Around the Lamp – end of an era

It is with considerable sadness that one of Painswick's most cherished and treasured groups is to draw to a close. Around the Lamp has meant so much to so many of those who grew up in Painswick and especially in the 1930s and 1940s. It is though precisely that fact which means the numbers of members are becoming so few that it is impractical to continue.

Originally named The 30's Kids, the group was formed in 1993 when a handful of people who had attended Painswick primary school in the 1930s met at the Clypping Service and decided to organise a bigger get-together of past pupils. Little did they realise how popular and successful that would turn out to be. They set to with true gusto and lo and behold the following year, as a result of their organising efforts, almost 100 former pupils arrived as well as five press reporters. It was a remarkable achievement, an overwhelming success and was the beginning of many years of very welcome reunions.



Sue Halliday, David Barnes and Pet Barnes

Harold Pearce was at the centre of the coordinating group and did much to encourage members to record their memories. A year later, 1995, with the help of a grant of £400 from the Gloucestershire Rural Arts Scheme, the first edition of The 30s Kids Clarion was published, a biannual newsletter which ran to 12 editions. In 2001, due to ill health, Harold could no longer continue in his editorial role. He called a meeting of members to decide how the group and its publication might continue. A committee was formed and the name of the newsletter changed to Around The Lamp.

Membership by this time was about 165 and a further decision was made to change the existing reunion schedule of once every five years into an annual event. A Reunion Tea has as a result been held in the Town Hall on Clypping Sunday ever since. Always well attended these have been very happy joyful occasions but of course with fewer and fewer original members. The Painswick banner has also on these Sundays been proudly carried around the church by members. (A new banner was made a few years ago but does anyone know what happened to the old one?)

The newsletter, copies of which are kept in Painswick library, has been an invaluable link for ex-pupils and their families both here and across the world including Canada, USA, South Africa and Australia. However, as David Barnes, who has chaired the committee for many of the past years, says "Our members are now so few that it is impractical to continue and we, the last three committee members (pictured), Sue Halliday editor and printer, Pet Barnes treasurer and David Barnes chairman, have had to make the reluctant decision to end the group. The final issue of Around The Lamp was the spring issue 2023."

Thus ends a truly significant and distinctive local group which has provided real happiness, togetherness, memories and warmth for its members over the years. Signifying childhood spent in Painswick school in the 1930s and 1940s it really is the end of an important era.

Carol Maxwell

Traditional Songs from Gloucestershire

The next meeting of the Cotteswold Naturalists Field Club will be held on Wednesday 3rd May at 2.30pm in the Painswick Centre where there will be an opportunity to enjoy 'Songs from the Countryside' performed by Carol Davies and Choir. Carol is a retired linguist, an author and a passionate collector of English traditional songs. She is also a member of several music groups, one of which will be joining her for this performance. This will be followed by a talk at Box Village Hall at 2.30 pm on Tuesday 16th May when we will hear from Kirstie Bingham about 'The Work of the John Moore Museum'. Visitors are always welcome at our meetings; no booking required - please drop in or contact Jane Rowe on 813 228 for more information. (£5 charge for visitors, £2 for members, with membership still £20 per annum or £30 for two or more people at the same address).



Finally, advance notice of our excursion by coach to London, provisionally set for Tuesday 4th July, when we will have a guided tour of the splendid Royal Chelsea Hospital - home of the Chelsea Pensioners - followed by a choice of afternoon visits: either to the National Army Museum, or the Chelsea Physic Garden, both within walking distance. Booking details will be available shortly from Robert & Jane Mann, tel. 01453 872 243.

Sylvia May cnfsecretary1@gmail.com

FRASER HALL

MINI DIGGER WORK: ALL TYPES
GARDEN MAINTENANCE
DRIVEWAYS & FOOTINGS
AGRICULTURAL FENCING
TREE SURGERY
SEASONED FIREWOOD

M: 07766 132 903

FULLY INSURED
BASED IN HARESCOMBE

Dr Hauschka Organic Facials

Your friends will ask enviously
if you've "had work done..."
But you'll smile secretively,
knowing you look great, naturally.

Book yourself a Dr Hauschka treatment
with **The Organic Beautician**
and treat your skin to the visible difference

text 07961 224560
jane@theorganicbeautician.com

Mention this ad when booking for a free Cleansing Cream
Based in Pitchcombe since 2007

PAINSWICK HOME & GARDEN

Renovation & Maintenance

- Lawns, hedges, fences, borders
- Landscaping, paving, stonework
- Bespoke-built log stores & bin stores
- Decorating, home repairs & lots more!

Find Us on Facebook

Call: 07532 111114

www.painswickhomeandgarden.com

An Honour Retrieved

To have an ancient honour bestowed upon you nowadays is indeed something special and for Painswick resident David Carlile this has proved to be the case. On 16th March David, wearing the customary robes, attended a ceremony at the Gloucester City Council Offices where he was sworn in as a chartered Freeman of Gloucester, this by swearing a solemn oath on a very precious old bible.



The chartered Freemen of Gloucester, and all towns and cities, date back many centuries and were certainly evident as men of status in feudal times. Generally they were men who had served an apprenticeship and the title gave them preferential trading and grazing rights, freedom from paying tolls but also moral obligations locally. From mediaeval times to be a Freeman of a city signified status, privileges and freedoms not available to the majority of the population of that city.

Who could be a Freeman? There were four ways: a system of patrimony was always one, but only the sons of Freemen were eligible; completing an apprenticeship (7 years) to a Freeman gave the right; a payment made, usually by farmers and yeomen; and, on a rather different level, it could be the gift of the mayor in recognition of services rendered.

So how did David discover his right to claim the honour? He did know that his grandfather had been a Freeman and assumed that, as he had had no sons, only a daughter (David's mother), the right had ceased to exist – only sons could inherit. However, in 2010 the rules were updated and female descendants were now included. David decided to investigate the possibilities and realised he was now eligible, especially as his mother had died. It also led him into some fascinating family history research to try to discover how and when it all began.

So far he has been able to ascertain the fact that his great great great grandfather, John Hyett, 1792-1845, a yeoman, was a Freeman of Gloucester. His continuing research may perhaps reveal previous ancestors as Freemen, but in any case David has enjoyed discovering much about his family's history in the course of his research. He is a volunteer at the family history centre in the county record office and is also a town guide with the Civic Trust in Gloucester.

David explains that he used to feel a sense of slight indignation and annoyance that female descendants were denied the hereditary right. With the perhaps long overdue change to that rule however, and his consequent new title he feels a sense of pride and belonging to Gloucester, a truly historic and very significant city. Asked about his new rights he does point out that he is, for example, now allowed to drive a herd of sheep through the streets of Gloucester and is also free to draw his sword (which he is holding in the picture) on the Gloucester Cross. However, he has no plans to do either in the foreseeable future! The honour is sufficient in itself.

Carol Maxwell

Painswick Probus Club

On 29th Mar 2023 the Club met to learn about Belarus but unfortunately with 24 hour's notice the speaker had to withdraw due to illness. Efforts to find a replacement failed so series of questions of quiz was hastily grabbed from the internet. Ad hoc teams of 4 competed for an undisclosed prize. The winning team comprised Mike Steed (Immediate Past President, still), Michael Campbell, Michael Cartledge, and Ian Eastwood. Liquid prizes which allegedly were "good for you" were awarded at the subsequent meeting.

On 12th Apr 2023 Probus Club attendees were treated to a compelling account of the early part of Charlie Chaplin's career, which was anything but a cause for laughter. The account was delivered by Paul Murphy who had found more than enough material to justify dividing the talk into 2 parts. Part 1 covered Chaplin's childhood and his efforts to achieve his emerging dream of performing on stage and making people laugh.

Born in 1889 on a gypsy site near Birmingham Charlie left no official trace of his existence in UK's archives - no birth, marriage death certificates. His father, Charles, was a music hall entertainer, but also was a drunkard and abuser, who left the family when Charlie was 2 years old. Charlie's mother, Hannah, also an entertainer, managed to support Charlie and his elder brother Sydney while her singing voice permitted but this was fading fast. When her singing voice completely failed on stage, the event manager, fearing a riot, led the 4-year old Charlie onto the stage. His singing performance was amazing; the audience ceased throwing fruit and started to throw him money. Hannah had to resort to the workhouse where mothers were separated from their children and Charlie's life was grim. Occasionally

Hannah would get paid work and could leave the workhouse and get her boys to school - where they found the conditions even worse. Next, Hannah was declared insane and spent periods in an asylum; Charlie and Sydney were sent to their father who had remarried. His new wife hated the responsibility for his children and was also a drunkard so Charlie's life by now was sorrowful indeed.

Charlie was always on the lookout for jobs in entertainment. Responding to an advertisement to join a clog-dancing troupe, he was taken on with no dancing experience. Meanwhile, Sydney Chaplin had joined Fred Karno's prestigious comedy company in 1906 and, by 1908, he was one of their key performers. He managed to secure a two-week trial for his younger brother which led to acting opportunities and international travel. By the age of 24 Charlie was famous, with prospects of a career in entertainment established.

We look forward to hearing more about Chaplin in Part 2 as his career broadened into film.

Henry Hall



HUNTER • PEARCE
D E C O R A T I N G

Reliable and Professional Service
Interior and exterior work
Paint and colour advice upon request

CONTACT

☎ 07733434773
✉ info@hunterpearce.co.uk

Purely Paws Dog Walking

Please contact Penny
Mobile 07748 726673
purelypawdogwalking@yahoo.com

Swing from Paris: live jazz & swing music

On Friday 19th May we welcome to the Beacon hall stage Swing from Paris, a UK quartet who've been called one of The Cotswolds 'finest jazz acts'. They've appeared at international festivals, playing classics from the 1930s and 40s. Join us for a fabulous night of live music, with bar. Tickets £16, available from www.painswickcentre.com and Eventbrite.

Morning Market

Our wonderful little market is becoming something of an institution in the village. It takes place in our car park every Thursday 8.15-9.45am. If you haven't been yet please come along to find some of the best local produce and suppliers from within a 5 mile radius of the village. Who's there can change a little week by week as these are all small businesses (join the Painswick Morning Market Facebook group to keep updated on who'll be there each week) but we are very proud to host: SALT Bakehouse, Bisley Lane Farm, Golden Sheep Coffee, Armadeli, A Wild Garden, and Wick Street Farm. Lucy and the Box have been a vital part of the market since the beginning, but now she's on maternity leave you'll still be able to get hot freshly ground coffee at the market courtesy of Michael of Golden Sheep Coffee (roasted in Stroud). See you there!

Food Nights

Incredible street food comes to Painswick every Thursday, serving to takeaway 5-8pm, cards accepted.

4th May	Mama's Family Food , homemade hearty Jamaican food
11th May	Soul Fries , handcut fries with homemade toppings
18th May	Bella Mia , fresh & hot sourdough pizza
25th May	Burgerlish , organic grass-fed beef & vegan burgers

Dates for your diary

Every Thursday **Morning Market** with local produce, 8.15-9.45am
Takeaway Food Nights serving 5-8pm

Every Tuesday	Massage & Reflexology appointments available with Blossom Robin
Thu 1st May	First Thursday: In conversation with Tom Herbert, 7pm
Fri 12th May	Wick-Flix presents A Man Called Otto (see more below)
Fri 19th May	Swing from Paris, live jazz music, 8pm

For details of all this and everything else happening at the Centre, check out our website (www.painswickcentre.com). We're also on Facebook and Instagram. Our noticeboards at the bottom of Bisley Street are also a great place to find out what's happening. If you would like to be included on our email list so we can keep you up to date with what's on, please complete the form on our website homepage or email marketing@painswickcentre.com.

Susie Andrews



Wick-Flix presents A Man Called Otto Friday 12th May

This month the Wick-Flix team bring you A Man Called Otto, starring Tom Hanks as a grumpy widower whose only joy seems to come from putting up the hackles of everyone he meets. But when a lively young family moves in next door he seems to have met his match in the forthright mum Marisol, and so starts an unexpected friendship that turns his life upside down.

"Even the most sceptical of moviegoers will be moved by A Man Called Otto's undeniable warmth and timely message about looking past one's surface to see the person inside."

Chad Byrnes, LA Weekly

Wick-Flix is a very special community cinema with a unique atmosphere. Doors of the Beacon Hall at The Painswick Centre open at 7pm, so come along and join us for a drink beforehand (your first one is included with the ticket price). We have a fixed capacity so it's best to arrive sooner rather than later to ensure you are not disappointed. Tickets are £9 on the door, cash or card accepted; the showing starts at 7.45pm, and there will be an interval for more drinks at the bar and sweet & savoury snacks. We are delighted to serve Woodchester Valley Vineyard wines and Marshfield ice creams at our showings. With big thanks to our gold sponsor Murrays Estate Agents, and sponsors Woodchester Valley Vineyard and JW Goddard's.

Wick-Flix Steering Group



**Glass Balustrades, Juliet Balconies
Shower Screens, Splash backs
Glass doors and Screens, Mirrors**

07717 741 275
Simon@uniqueglassolutions.co.uk
www.uniqueglassolutions.co.uk
Painswick based

**Turnstone Acupuncture
& Chinese Herbal Medicine Practice**

Simon Robey MBAcC, MRCHM

Acupuncture - Chinese Herbal Medicine
- Massage - Mindfulness Meditation

Greenhouse Lane Painswick GL6 6SE

07799 742498
turnstone2021@gmail.com
painswickacupuncture.com



**IAN RICE
BUILDING
Limited**

Extensions, Conversions, General Building
Free, no obligation estimate

01453 821555
07980 945126
ianricebuildingltd@gmail.com
www.ianricebuilding.com
3 Perth, Stonehouse, GL10 2PT

Painswick Sports

assembled by John Barrus

Falcon Bowling Club

Stuck for ideas of how to spend Whitsun Bank Holiday then come along to the Falcon Bowling Club in Painswick and join in the National Big Bowling weekend.

Try something new that anyone regardless of age and ability can do, you never know you might find it's fun!

We are open on Friday 26th May from 10am till 4pm and Monday 29th May from 2pm to 8pm. The bar will be open and refreshments will be on sale at very reasonable prices.

Bowls will be provided and shoes must have flat bottoms to avoid damage to the green.

For more information contact Suzi Pockett on 07786275316. Hope to see you soon



Suzi Pockett

Painswick Golf Club

The seasons move on, and our golf calendar moves from the winter season into summer – though it does not really feel properly summery yet!

In the Seniors section, the winter season concluded with the final rounds of the Winter Pairs competition. This better ball competition was played in teams of two, one round each calendar month from October to March, with the best five rounds counting. The winners were Brendan Nunan and Dave Butler with an aggregate score of 231 points, four points ahead of Duncan McCarroll and Nigel Barnett. The summer season of cup and trophy competitions started with the Arthur Paget Putter Trophy, held on 23 March. Boo Hussain was the runaway winner – with a superb score of 49 stableford points, some 7 points clear of Ian Broderick, his nearest rival. The midweek stableford competition on 6 April was won by Brendan Nunan with an excellent score of 39 points, closely followed by Gil Locke and Peter Rowe, both with 38 points. Congratulations to the winners.

Over the summer months, the seniors hold friendly matches with other local clubs and the first two resulted in a win and a draw. Good luck for the rest of the season.

Visitors are welcome at Painswick Golf Club. As many will know, catering at the present time is very limited. Currently, limited refreshments are usually available on Tuesdays, Thursdays, Saturdays and Sundays from 11am to 2pm and occasionally at other times. Catering options for the future are being investigated but there are no immediate solutions. For more information about booking tee times, please call 01452 812615.

Peter Rowe

Painswick Cricket Club

Off we go, Painswick Cricket Clubs 2023 season begins with the following home fixtures at Broadham Sports field,



- Saturday 6 May 2nds versus Kings Stanley 1sts
- Sunday 7 May Cup match against Frampton on Severn (County Lge)
- Saturday 13 May 1sts versus Goatacre 1sts (West of England Premier Div 2 Glos/Wilts)
- Saturday 20 May 2nds versus Lechlade 1sts (County Lge)
- Saturday 27 May 1sts versus Thornbury 1sts (West of England Premier Div 2 Glos/Wilts)

Midweek fixtures are listed on the Painswick CC play cricket website.

Please feel free to pop in and see our teams play, normal start time is 1300 or 1330.

We will publish regular updates/results etc in the Beacon over the summer months,

Steve Pegram

Short Mat Bowls

Are you busy on Monday afternoons? You may wonder why the question is being asked! On a Monday afternoon, at 2.0pm, the Short Mat Bowls Club meets in the lower room of the Town Hall to enjoy an afternoon of fun and competition.

Short Mat Bowls is similar to "Outdoor Bowls" but is played indoors on a Mat instead of outdoors on grass. The Mat is shorter than an outside Green. Our main advantage is that we can play for 12 months of the year, watching the rain fall from the comfort of the warm Town Hall!

All equipment, including a selection of "Woods," is available to Members and tea/coffee and biscuits plus interesting conversations are served at half time. To help protect the Mat you will need to wear soft soled footwear.

We have vacancies for new Members so why not come and join us on Mondays? If you've not played before we will be delighted to introduce you to the game and after a few weeks you will wonder why you have not previously joined the Club!

There is a charge of £2 per session to cover the cost of refreshments. For new Members there will be no charge for their first two Meetings.

We are looking forward to MEETING YOU on a Monday and introducing YOU to the sport of SHORT MAT BOWLS. Let's see how close to the "Jack" you can bowl!!

Mike Kerton

**Julian Telling
Garden Services**

****New Service - Green Waste Collection****
We supply 1 bulk (tonne) bag
You fill it, then call for collection - £20.00

Tree Felling, Pruning & Maintenance, Fence Maintenance & Erection, Lawn Cutting, Strimming, Turfing, Weed control, Hedge Cutting & Shaping, General Garden Clearance
Gutters & Patios cleaned, Exterior Decorating

07895 224863
Juliantelling@yahoo.co.uk

Reflexology & Massage

With Blossom Robin
Every Tuesday at
The Painswick Centre
to book contact: 07552 653651
sblossomrobin@gmail.com
www.blossomrobin.co.uk

KP Garden Machinery

Service and repair of all types of domestic garden machinery including mowers, hedgecutters, strimmers, chainsaws and leaf blowers

07976 022640 / 01453 886504

www.kpgardenmachinery.co.uk
enquiries@kpgardenmachinery.co.uk
16a Hope Mills Business Centre, Brimscombe GL5 2BE

22/23 Winter season



We have now finished major work parties for the summer and despite numbers being slightly down on last year we still recorded an impressive 750 hours, not including any work associated with the cows or administration. I would like to publicly thank all those who have turned up and worked so hard, sometimes in pretty foul weather. The ecological quality of some areas has improved hugely, partly because of what we do, but mainly through the efforts of our Dexters. They have been out on the Beacon for nearly seven months. Next year we have had permission to graze them all year, weather permitting. We will use a bowser to allow summer grazing in recently cleared areas, for what is classed as restoration grazing. This is when rougher grass, larger “weeds” and shrubs are browsed for successive years to allow the more delicate, desirable herbage to flourish.

We have secured major funding from Natural England and the County Council to resurface a 450m section of the Cotswold Way. The long flat section past the ramparts had become extremely muddy and adjacent, good quality, grass was being damaged as people strayed off the track to avoid the mud. This work has now been completed.

Several sites cleared 4-5 years ago were revisited for follow up clearing. Brambles are cut back and raked off, then it is possible to see what is growing back and decide whether to push further back into the secondary woods. We started on two new areas along the bank of the 15th fairway and at the extreme Royal William end. Ash Dieback continues to be a problem as dying trees become brittle and unstable, potentially causing a safety risk. Many were removed from the Holcombe bridleway which has helped our effort to turn this into a more diverse open ride. To help this end we transplanted spindle and cherry saplings from another part of the Beacon.



Some small scale work parties will occur during the summer. These will include collecting plug plants for transplanting in the autumn, scything, and a small amount of spot spraying bramble re-growth. If you would like to help with any of this please contact me on 077971 633 242 or pmbaxtersfm@gmail.com

Paul Baxter

Painswick Gardening Club



Caroline Sheldrick’s enthralling talk on Medicinal Herbs in the Garden was a fascinating look into what culinary herbs, ornamental and wild plants we can use from our gardens to treat an immense range of medical problems. No need to rush to the pharmacy if we can start treating ourselves with what we have growing in our gardens. But beware of foxglove, lily of the valley and monkshood!

So far this year we have enjoyed talks on Secret Gardens in the Cotswolds, specialist vegetable growing and looking after the creatures in our gardens.

Our next topic is Gardening with Sustainability in Mind. On 12th May Emile Woodger-Smith will cover topics relevant to sustainable gardening for the planet, including composting and ways in which we can help the wildlife in our garden. We will be able to take part in making sustainable up-cycled seed pots. Emile is a waste industry professional by trade and she uses her experience, environmental degree and longtime love of sustainability to create and share information with others.

Do come along to the Town Hall for refreshments from 7 pm with the talk starting at 7.30 pm. Visitors are always welcome.

Philippa Miller



CHORLEY'S

YOUR LOCAL FINE ART AUCTIONEER

Free auction valuations
Regular fine art & antiques sales
Insurance & probate valuations

01452 344499
enquiries@chorleys.com
www.chorleys.com

PRINKNASH ABBEY PARK, NEAR PAINSWICK, GL4 8EU

BANCROFT  LIVINGSTON

— BATHROOMS —

Bespoke bathroom design and installation

jake@blbathrooms.co.uk
www.blbathrooms.co.uk

St Michaels

BISTRO

Lunches: Wed - Sun 12.00 - 15.00
Evenings: Tue - Sun 18.30 - 22.00

tel: 01452 203306
07877 282 446

marinpetre1967@gmail.com

Take-aways available

Your local area electrician



MJBoon

Electrical

☎ 07773 626241
✉ matt@mjboonelectrical.co.uk
🌐 www.mjboonelectrical.co.uk

- Free estimates and advice
- All aspects of electrical work undertaken



APPROVED CONTRACTOR

Regular Village Activities. Please contact Vicky Aspinnall on cvasp.26@gmail.com

Mondays	Gentle pilates. Info from Heidi 07970 262538	Painswick Centre 8.45 - 9.45am	
	Improvers pilates. Info from Heidi 07970 262538	Painswick Centre 9.50 - 10.50am	
	Beginners/improvers pilates. Info from Heidi 07970 262538	Painswick Centre 10.55 - 11.55am	
	Ballyhoo modern dance classes (primary grade modern). Info from Julie ballyhoochalford@gmail.com	Painswick Centre from 3.45pm	
	Community Choir. Contact sophie@sophiesterckx.co.uk	Painswick Centre 7.00 - 8.30pm	
	Short Mat Bowls. All equipment provided. 2.00/session	Town Hall 2.00 - 4.00pm	
	Mindful Meditation with Kate. www.kate-beatty.co.uk/07793126234	Painswick Centre 12.30 - 1.00pm	
	Painswick Singers. Contact Jean Jones 01452 813545.	Richmond 7.30pm	
Tuesdays	Painswick Bootcamp. Details contact Becca Meadows 01452 451505 or info@beccameadowsnutrition.co.uk	Broadham Field Rugby Pitch 7.30 - 8.30pm	
	Drawing classes. Info from Susan Skester skester@outlook.com	Painswick Centre 9.30 - 12.00pm	
	Zumba with Martina 07891 194396	Painswick Centre 9.45 - 10.45am	
	Painswick Art Club	Church Rooms 9.30 - 1.00pm	
	Rococo Sprites. See www.rococogarden.org.uk	Rococo Garden 9.45 am	
	Wednesdays	Strength and Balance class for the over 60s. Contact Trish Tenn on 07956 4666617 or tennpatricia@gmail.com	Church Rooms 10.00 - 11.00am
		Painswick Bridge Club. Contact Peter Sibley on 812126 or Margaret Wilson on 812305	Church Rooms 7.00pm
		Table tennis. Contact David on 01452 812464	Painswick Centre 7.00 - 8.30pm
Yoga with Kate. www-kate-beatty.co.uk/07793126234		Painswick Centre 7.30 - 8.45pm	
Classical Pilates Mat Classes with free taster. Contact Jo on 07968 799741 or info@joannedaleypilates.com .		Painswick Centre 10.30 - 11.30am	
Strength and Conditioning Circuits. www.lovelifeladies.co.uk		Painswick Centre 12.30 - 1.30pm	
After school art classes. Email classes@painswickcentre.com . Term time only		Painswick Centre 3.45 - 5.15pm	
Thursdays		Morning Market	Painswick Centre 8.30 - 9.30am
	Yoga. Contact Kim on yoginikim@icloud.com	Painswick Centre 9.30 - 11.00am	
	Nurturing yoga. Contact Kim on yoginikim@icloud.com	Painswick Centre 11.15 - 12.45pm	
	Tai chi. Contact Joe on 07960 753782	Painswick Centre 1.30 - 2.30pm	
	Dog Training Club. Contact Fiona Chapman on 01452 812462 or fiona.chapman123@btinternet.com	Church Rooms 10.00 - 12.00pm	
	Qi Gong Classic Exercise - contact Jeff Docherty on jeffdocherty@yahoo.com	Town Hall 9.30 - 10.30am	
	Classical Pilates Mat Classes. Contact Jo on 07968 799741 or info@joannedaleypilates.com .	Town Hall 5.45 - 6.45pm	
	Takeaway Food Night	Painswick Centre 5.00 - 8.00pm	
Fridays	Yoga for Backs. Contact Kim on yoginikim@icloud.com	Painswick Centre 9.30 - 11.00am	
	Ballet with Claire Tracey. Contact BalletClaire@outlook.com	Church Rooms 9.30 - 10.30 am	
	Painswick Community Hub Café: serving tea, coffee and homemade cakes. All welcome	Town Hall 10.00 - 11.30am	
	Church Choir Practice. Contact Chris Swain cgsvain@btinternet.com or 01453 822998	St Mary's Church 5.30 - 6.30pm	
	Classical Pilates Mat Classes. Contact Jo on 07968 799741 or info@joannedaleypilates.com .	Painswick Centre 11.00 - 12.00pm	
	Tea, cake & watercolours art course starts April 14th for 6 weeks	Painswick Centre 2.00pm	
	Painswick Baby and Toddler Group - Term time only	Youth Pavillion 9.30 - 11.30am	
	Sundays	Mass	Catholic Church 8.30am
Quaker Meeting for Worship		Meeting House 10.30am	
Aikido www.gloucestershireaikido.club .		Painswick Centre 8.30 - 11.00am	

Village Diary

Please let me know your club and society dates for the diary on cvasp.26@gmail.com

April 29 Painswick Beacon published

May

Wed	3	Cotteswold Naturalists: Songs from the Countryside - Carol Davies and Choir. Enq 01453 873262	Painswick Centre	2.30pm
	6	Painswick Music Society: La Serenissima. Book online at painswickmusicsoc.co.uk for membership/tickets. Enq to Edward Bowron 07789 006006	St Mary's Church	3.00pm
Mon	8	Bank Holiday		
	8	WI Cream Tea - all welcome	Church Rooms	2.30 - 4.30pm
		Painswick Community Support Group: Coronation BBQ. All welcome	Recreation Ground	12.00 - 3.00pm
Weds	10	Painswick Probus: The Brain - Prof Colin Terrell followed by finger buffet (joint meeting with the ladies)	Painswick Centre	10.00am
	10	Gardening Club: Gardening with sustainability in mind - Emilie Woodger-	Smith Town Hall	7.00 for 7.30pm
Thurs	11	Painswick Music Appreciation Group: End of season party and members selections	Town Hall	7.30pm
	11	Arts Society: The World of the Bayeux Tapestry - Rupert Willoughby	Painswick Centre	10.45am
Fri	12	Friday Club: 'Wild Hogs' Hedgehog Rescue	Town Hall	2.30pm
	12	Wickflix: A Man Called Otto	Painswick Centre	7.00 for 7.45pm
Sat	13	Hampton's Charity Plant Sale in aid of MIND and Cancer Research	Painswick Centre	10.00 - 2.00pm
Sun	14	Holy Communion (Sports Sunday)	St Mary's Church	10.00am
Tues	16	Painswick Beacon Conservation Group: Wild gardening and wildlife corridors	Town Hall	7.00pm
	16	Cotteswold Naturalists: Work of the John Moore Museum, Tewkesbury - Kirstie Bingham. Enq 01453 873262	Box Village Hall	2.30pm
	16	Christian Aid Salmon Supper - tickets £20, advance booking required - ring 812966 or 810935	Church Rooms	7.00 for 7.30pm
Wed	17	Cotteswold Naturalists: Visit to Kelmscott Manor - tour and lunch. Pre-book 813228	Manor car park	by 10.00am
Thurs	18	Cotteswold Naturalists: Guided Walk - trees of Sheepscombe. Pre-book 813228	Sheepscombe Village Hall	10.00am
Fri	19	Christian Aid Garden Shop - ploughman's lunches (12-2) and cream teas (12-4)	Church Rooms	11.00 - 4.00pm
Sat	20	Christian Aid Garden Shop - ploughman's lunches (12-2) and cream teas (12-4)	Church Rooms	11.00 - 4.00pm
Sun	21	Morning Worship with Baptism	St Mary's Church	10.00am
	21	Deadline for Beacon Copy		
Mon	22	Library Book Club	Library	1.30 - 2.30pm
Tues	23	History Society: Annual Outing - Woodchester Mansion		
	23	Yew Trees WI: A Ride Around England - William Roddaway	Church Rooms	7.00 for 7.30pm
Weds	24	Painswick Probus: Michael Houghton by Michael Houghton	Painswick Centre	10.00am
Fri	26	Friday Club: Outing to Slimbridge		
Sun	28	Beacon Praise	St Mary's Church	10.00am
Mon	29	Bank holiday		

June

Sat 3 **Painswick Beacon published**

Peter Barnfield
Painter & Decorator
 All Interior, Exterior + most DIY work
 30 years experience



Tel: 01452 610199
 Mob: 07881 408380
 Email: Barnfield.peter2@gmail.com

The Help Group
ESSENTIAL CARE AND NIGHT STAYING SERVICES

CALL OUR FRIENDLY TEAM
01285 330050
WWW.THEHELPGROUP.CO.UK

OFFERING QUALITY ASSISTANCE IN YOUR HOME...
 LIVE-IN CARE - HOME HELP & COMPANIONSHIP
 PRIVATE CHEFS & MEAL PREPARATION - HOUSEKEEPING

Your help at HOME



**Professional Ironing,
 Dry cleaning, Laundry,
 Repairs/Alterations
 & Shoe repairs**

COLLECTION & DELIVERY AVAILABLE

Tel: 07952006820
www.ironeasy.biz

Painswick Surgery Patient Group (PPG)

The patient group met with the Practice at the end of March with Dr Matt Heywood and three staff present. We appreciate such a high level of engagement from Practice staff.

We also had as a guest the Associate Director, Engagement and Experience NHS Gloucestershire, Becky Parish to update us on County-wide issues. She explained (again!) the replacement of the Clinical Commissioning Group by the Integrated Care Board which oversees the Integrated Care Services for the County, the key aspect of which is that they are responsible, with the County Council, for Social Services as well as Health. Their main task is to commission services from providers such as GPs, hospitals etc covering mental as well as physical health.

Becky Parish will oversee a County-wide patient survey this summer which we will have opportunity to learn from and contribute our own questions to in a follow-up. This should come to you later in the year.

Practice update

We heard that the Surgery, with many more appointments requested than was the case pre-pandemic, continues to operate under stressful conditions, despite employing an extra doctor that the NHS does not fund. Recently everything has been complicated by moving to both a new website provider and whole IT system to come more into line with other local practices etc that they increasingly work closely with. The Practice staff are convinced that the new IT system will bring significant benefits once settled-in. Meanwhile, problems with patients accessing their personal records through the NHS app also continue. Despite this we are encouraged to adopt the NHS app if possible and use it to order repeat prescriptions, Covid passes etc.

One problem raised concerned patients who were at work or away from phone contact when expecting a call-back from a Doctor, not knowing when they would be called. It is difficult for Doctors to schedule call times in advance but patients in these circumstances are advised to let the Practice know, including when in the day they will be able to take a call, when they are advised to expect one.

PPG Procedures

After some discussion the Group decided that in principle we should hold an annual general meeting. We are to meet again soon to discuss this further and consider other activities to combine with an AGM to make it worth coming to.

PPG Code of Practice

This governs the way we work and we have brought it up to date recently. It will shortly be available on the Practice website.

Scams

Whilst we have increasing cause to worry about online scams, the Practice is suffering from numbers of patients phoning them every time a legitimate text or email is sent by them to a batch of people. Scams must be taken seriously but if you receive a text message apparently from the Surgery that concerns you and there is no reason why responding to it would put you in danger then please trust it.

Text messages from the surgery will usually have a sender's name of GPSurgery or NHS-NoReply. If there is a clickable link, then it will usually contain the text accurx.nhs.uk. If there are other words or symbols you might need to check further but there is a need to keep direct checks with the Surgery to a minimum.

Wider Issues

Patient Group members continue to be concerned about developments in the local acute hospitals trust (Cheltenham General and Gloucester Royal) including reports of a hostile internal culture following the CQC inspection last year downgrading their 'Well Led' criterion to 'Requires Improvement'. Together with ambulance queues, closures of Maternity provision and the Trust having the third worst death rates in the country this amounts to a worrying situation for us all.

Prescription pre-payment cards

Lastly a reminder that paying patients needing regular repeat prescriptions might save money by buying a pre-payment card. If this might include you, ask your Pharmacist.

David Perry, Chair

Contact us on painswickppg@gmail.com - but be careful not to muddle this with the Practice's email address: painswick.surgery@nhs.net

Simon Gyde
Carpenter and Joiner
City & Guilds
Purpose Made Joinery
Restoration Woodwork
General Building Services
07768.173726 simongyde@yahoo.co.uk

 **Kate Rich** 
walks Painswick's
'Diamond Dogs'
Stimulating Dog Walks
that include the best 'sniffy places' to
delight your dog
Also: Bespoke Dog Sitting Service
Tel: 07785 562616
www.katerich.co.uk

THE SHARPENING SERVICE

Kitchen knives, garden tools,
.... and most other blunt items!
For a speedy turnaround
Call **Rupert Miles in Bisley**
01452 770788
milesrup@btinternet.com

PLANNING MATTERS

Information received from the Parish Council

NEW APPLICATIONS

S.23/0813/HHOLD

Tilia Castle Close Painswick

Erection of single storey garage and workshop extension, single storey front porch, first floor dormer to front and first floor gable extension to rear with associated external material changes

S.23/0749/FUL

Land At Briar Cottage Sheepscombe

Erection of a single dwelling & associated works

S.23/0755/HHOLD

Edgewood Longridge Sheepscombe

Raise the ridge line, erection of single storey rear extension and alterations (Amendment to S.22/1391/HHOLD)

S.23/0708/HHOLD

Chestnut Cottage The Park Painswick

Erection of two storey side & single storey extension. (Resubmission of S.20/0342/HHOLD)

S.23/0654/HHOLD

Ridgewood Queens Mead Painswick

Replacement of existing porch canopy with enclosed porch.

S.23/0631/HHOLD

Mirfield Stroud Road Painswick

Erection of first floor extension, change of external materials and replacement garage. (Alterations to S.22/2437/HHOLD)

S.23/0532/HHOLD

Southwood Jacks Green Sheepscombe

Erection of single storey pitched annex.

CONSENT

S.23/0636/MINAM

Brooklands Cottage Sheepscombe

Non-material amendment to S.22/1794/HHOLD - reposition the storage shed and alteration to construction material.

S.23/0435/LBC & S.23/0434/HHOLD

Coach House The Grange Sheepscombe

Conversion of coach house to ancillary accommodation (retrospective).

S.23/0185/HHOLD

Hedges Gloucester Street Painswick

Proposed rear extension. Alterations to fenestration

S.23/0386/LBC

Court House Hale Lane Painswick

Regularisation of windows and appropriately detailed openings and features within the Barn and 'Hamlet suite'

S.22/2026/LBC

Wool Cottage Victoria Street Painswick

Proposed replacement front door

S.23/0084/HHOLD

The Byre The Park Painswick

Erection of two storey extension. (Resubmission of S.22/2165/HHOLD)

S.23/0471/TCA

22 Gloucester Road Painswick

T1-T7 - Beech Trees- Reduce height by 20-25 feet

Foodbank

Our next collection in Painswick will be on Wednesday 10th May, 10am -12 noon in the Stamages Lane car park and at the Stocks by the Church.

At this collection, please may we ask for some of the following: cooking oil, Fray Bentos pies, hot dogs, peanut butter, Marmite, jam and marmalade, nuts and crisps, fruit squash, biscuits and sweet treats, shampoo and conditioner, shower gel, razors and shaving gel, toilet rolls, household cleaning sprays, laundry detergent, nappies sizes 4,5,6 and 7.

If anyone would like to donate but is unable to get to the donation point, please call 07950 651228 and we will endeavour to collect from you.

If you wish to make a bank donation, you can do so using the following details:

Stroud District Foodbank CIO

Sort code: 09-01-29

Account: 21994911

Thank you!

The Foodbank Team

Property Report

There is little new on the market in Painswick this month. Murrays have The Old Fleece and shop in Bisley Street at £415,000, which is a large Grade II Listed 2 bedroom apartment with impressive vaulted sitting/dining room and commercial retail or office space underneath. Hamptons have Hillside Cottage in Paradise at £700,000, a 3 bedroom detached stone cottage, with some scope for renovation, which has been in the same family ownership since around 1880. And that's about it.

Properties are still selling though. 4 St Marys Mead, Upper Cottage in Tibbiwell Lane and Freshfield in Cotswold Mead are all under offer through Murrays, as is 17 Churchill Way through Hamptons. Tilia in Castle Close has exchanged and 6 Berry Close has completed. Multiple offers on this last property suggest a particular need for more properties in this area / price range, but in general, agents are crying out for more property to sell in the village.

Hamptons are running a plant sale and coffee morning on Saturday 13th May between 10 am and 12 noon in aid of Cancer Research and Mind. Plant donations would be gratefully received. And over the weekend of 16th June, James Murray of Murrays Estate Agents will be running the 4x4x48 endurance challenge to raise money for locally based charity, The Nelson Trust. This involves running miles every 4 hours, day and night, up to total of 48 miles over 48 hours. To support him, drop in to the office or go to <https://www.justgiving.com/fundraising/james-murray66>



MURRAY'S
SALES & LETTINGS

*Leading property agents for the
Stroud Valleys and Severn Vale*

We pride ourselves on our personable and professional approach, offering new and innovative ways to market your home

Contact James or Richard Murray

Offices in Painswick,
Stroud, Minchinhampton
and Mayfair, London



Painswick office: 01452 814655
www.murraysestateagents.co.uk

**WITH YOU
FOR EVERY
STEP**

Sales 01452 812354
Lettings 01242 263559
painswick@hamptons.co.uk

Hamptons
THE HOME EXPERTS

Personal column

Condolences

To the family and friends of GEOFFREY ARCHER, formerly of Bramble Cottage, Vicarage Street, Painswick who died suddenly and peacefully in April. His funeral will be at 12 noon on Thursday May 4th at Southport Crematorium and afterwards at the Masonic Hall in Ormskirk.

Geoff was a retired mathematics lecturer at Durham University and an excellent Bridge player. He was a very active part of the village during his lifetime and was a treasurer for the Theatre Club. He was also involved in many other clubs and societies.

You could help Vicky Aspinall, if you would send information about those you know for whom a mention in the Personal Column would be appreciated cvasp.26@gmail.com

Gardner Tomb Dismantled

On the 3rd of April the Gardner tomb just outside the church porch of St Mary's was dismantled and taken back to Centerline's workshop for restoration.



It is hoped that in due course we can get some pictures of the restoration in progress.

Additional copies of the Beacon
are available from the Premier shop or online, where the Beacon can be seen in full colour at www.painswickbeacon.org.uk

Printed in Gloucester for **The Painswick Beacon** by www.inkylittlefingers.co.uk
01452 751900

MINI-ADS

May 2023

'Noughty' Organic Sparkling Chardonnay Alcohol Free, 9 bottles bought last autumn. Perfect non-alcoholic alternative for parties. Paid ('mix 6') £7.49 p.b., available at £4 p.b. Collect Painswick. Contact virginia@richardfalconer.net.

South Devon Holiday Rental. A lovely four-bedroom house to rent in Thurlestone, South Devon. Ideal for beach, walking, golfing holidays and exploring the stunning South Hams region. Call Vicki 07789 963886.

Full set of wooden garden furniture, 4 armchairs with cushions and round table. £50. 01452 813815.

Stewart remote control golf trolley. With battery and remote. £150. 07899 777795

Rockery stone, various sizes - to be collected (from Painswick garden). Donations will be passed on to local charity. Call 01452 812226.

Wanted To Rent Unfurnished house /flat, 2/3 beds, outside space. Long Let preferred. Frances 07778 655220.

Painswick Golf Club seeks a **Clubhouse Cleaner.** 4 hours per week – 2 hours Monday am and 2 hours Friday am. £15 per hour. Please call George Paton 07810 115812.

One bedroom flat to rent in West London. Ideal for city breaks or for overnight business stays. Easy access from M4/A4 or by train to Paddington. Tel: 07912 756473.

Mini-Ads

Primarily for Painswick residents. Text maximum 30 words. Flat charge £5. Free to subscribers for private sales. £5 for business use, holiday rentals. etc.

Provide text, your name, address and contact details with payment in advance. Deadline as for all copy. More info call Peter Rowe, or mail: advertising.beacon@painswick.net

Disclaimer

The Beacon does its best to verify information published, but does not take any responsibility for the accuracy or reliability of information provided by other contributors. Paid advertising is accepted in good faith and we disclaim all liability for goods and services on offer.

NEXT ISSUE

Publication date
SATURDAY
June 3rd 2023

Deadline for all copy
Sunday 21st May

www.painswickbeacon.org.uk
for current issue and archive, the annual directory and village maps.

for editorial attention only use beacon@painswick.net or hard copy - preferably typed
Beacon post box - New Street

All copy must include author, address and contact telephone number. Photographs and advertising art work original at 600dpi in JPEG

The Beacon Team

Co-ordinating Editor this month
Peter Jackson 07985 002325
beacon@painswick.net

Editing Associates
John Barrus 812942
beacon@painswick.net

Alastair Jollans 814263
beacon@painswick.net

Next Month's Editor
Alastair Jollans 814263
beacon@painswick.net

Diary and Personal Column
Vicky Aspinall 812379
cvasp.26@gmail.com

Feature writer and Directory
Carol Maxwell 813387
features.beacon@painswick.net
directory.beacon@painswick.net

Sport
John Barrus 812942
barrusjp@yahoo.co.uk

Distribution
Celia Lougher 812624
distribution.beacon@painswick.net

Treasurer
Richard Aspinall 812379
treasurer.beacon@painswick.net

Advertising
Peter Rowe 813228
advertising.beacon@painswick.net

Subscriptions
Jacek Wolowiec 813295
subscriptions.beacon@painswick.net

Easter Egg Hunt



What a glorious day we had on Easter Saturday for the return of the annual Easter Egg Hunt to raise funds for our fabulous village Playgroup. The standard of cakes brought along for the cake sale and Painswick Bake off, judged by Cath Kidston, was incredible. Congratulations to Lucy John at The Oak who won the professional category with a Black



Forest Gateaux alongside some other truly decadent cakes from The Painswick Hotel, The Falcon, The Box, Handmade in Painswick and Meadows Painswick. In the amateur category, Penny Kikic won the best bake and Giff Morris won the best decorated cake. Cath was so impressed with the efforts of Rosalie Sutton, aged 10, she created a new category for under 12's and ensured she had a prize too. All the cakes were then sliced up and sold off to raise money for our community playgroup.



The playgroup staff ran a tombola stall, we had 21 prizes in the luxury raffle and were visited by the Easter Bunny over the course of the afternoon, who proved quite the celebrity with the kids. We also had stalls selling plants, flowers, bric-a-brac (clothes, toys, books etc donated by both playgroup and The Croft school parents - thank you!) Fairtrade Easter Eggs and the face painting stalls had a constant queue of very patient kids waiting in the sunshine. The bouncy castle also proved a real hit at The Painswick Centre as the children were making their way round the trail, hunting for the animal-themed eggs, and collecting letters to solve the anagram.



Thank you to The Parish Council for letting us use the memorial ground and recreation ground, St Mary's Church for supporting us and running a tea and coffee stall and to The Painswick Centre too. As ever, we are grateful to our main sponsor Hamptons for donating a £200 John Lewis voucher to one egg hunter and printing all our maps, posters etc. The Painswick hotel also generously donated chocolate prizes. We had 37 wonderful local businesses sponsoring our eggs this year: photos of all the eggs are on our social media for those who missed the trail.



But the biggest thanks go to our team of volunteers who tirelessly worked to help make the event the huge success it was. The committee are very grateful to everyone who helped give their time to help run the day, but also to all the volunteers who decorated some fabulously creative eggs for the trail. The weather was most definitely on our side, but we are delighted to report we have raised a record £6500 this year towards Painswick Playgroup Charity funds. We were all reminded of what a wonderful village Painswick is and the strength of our community spirit.

*The Painswick Easter Egg Hunt
2023 committee*

Debbie Hull, Alice Huggins, Jess Barnett, Tim Knibbs, Josephine Munsey, Clare Brehmer and Lucinda Ryan

